



FOR LEASE

Commerce Park Clackamas

BUILDING D, 16251 SE 98TH AVENUE, CLACKAMAS, OR



57,900 SF shell

3,906 SF office on two levels

17 dock high doors

2 drive-in doors

24' clear height

SPRINKLER system throughout

SKYLIGHTS provide natural light to warehouse

END-CAP unit with adjacent parking lot which may be secured for vehicle storage

STEVEN KLEIN

503.221.2260

steven.klein@kidder.com

PETER STALICK

503.221.2272

peter.stalick@kidder.com

COMMERCE-PARKS.COM

KIDDER.COM

This information supplied herein is from sources we deem reliable. It is provided without any representation, warranty, or guarantee, expressed or implied as to its accuracy. Prospective Buyer or Tenant should conduct an independent investigation and verification of all matters deemed to be material, including, but not limited to, statements of income and expenses. Consult your attorney, accountant, or other professional advisor.

**LINCOLN
PROPERTY
COMPANY**

**Kidder
Mathews**

FOR LEASE

Commerce Park Clackamas

BUILDING D, 16251 SE 98TH AVENUE, CLACKAMAS, OR

Building D

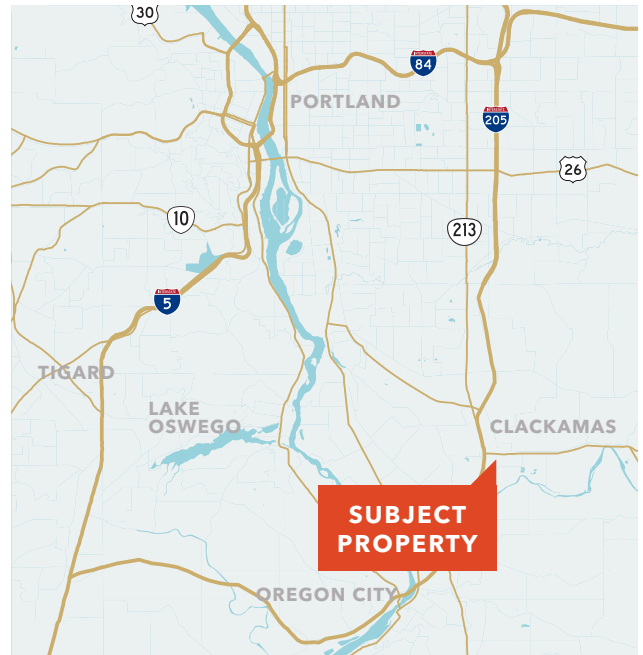
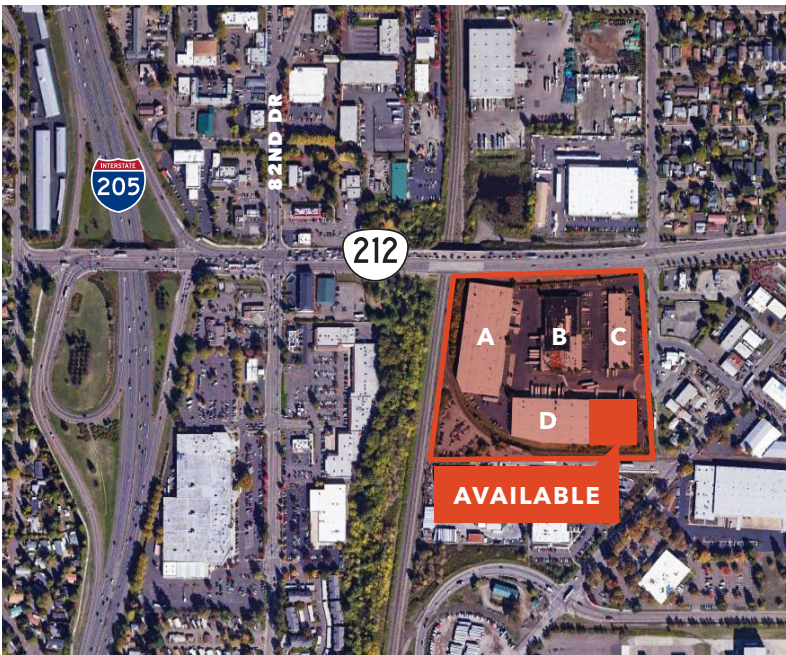
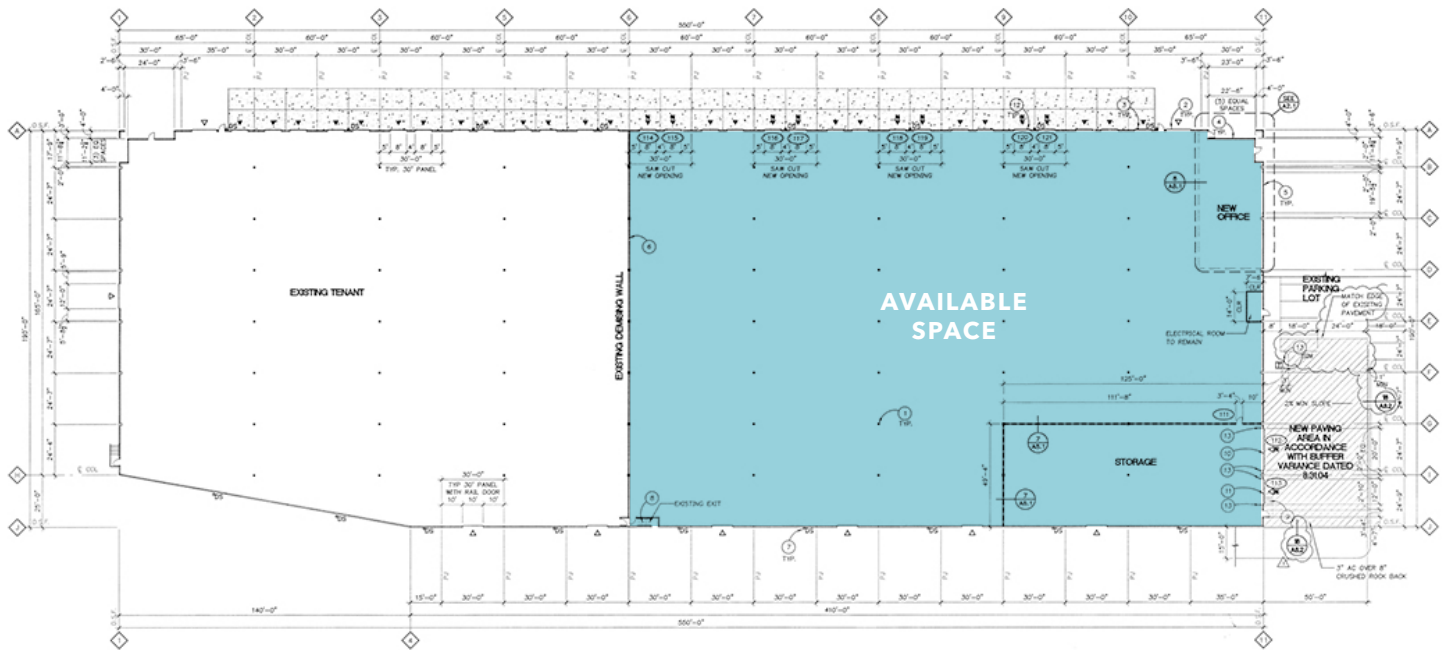

KIDDER.COM | COMMERCE-PARKS.COM

This information supplied herein is from sources we deem reliable. It is provided without any representation, warranty, or guarantee, expressed or implied as to its accuracy. Prospective Buyer or Tenant should conduct an independent investigation and verification of all matters deemed to be material, including, but not limited to, statements of income and expenses. Consult your attorney, accountant, or other professional advisor.

LINCOLN
PROPERTY
COMPANY

km Kidder
Mathews